

Z	d _e	d _p	SIMPLEX		
			d _m	D ₁	A
8	19.4	16.58	10	6	12
9	21.4	18.56	11.5	6	12
10	23.3	20.55	13	6	12
11	25.3	22.54	15	8	13
12	27.3	24.53	17	8	13
13	29.3	26.53	17	8	13
14	31.3	28.53	17	8	13
15	33.3	30.53	20	8	13
16	35.3	32.55	22	8	14
17	37.3	34.55	22	8	14
18	39.4	36.56	25	8	14
19	41.4	38.58	25	8	14
20	43.4	40.58	25	8	14
21	45.4	42.60	30	8	14
22	47.4	44.62	30	8	14
23	49.4	46.63	30	8	14
24	51.4	48.64	30	8	14
25	53.5	50.66	30	8	14
26	55.5	52.67	30	8	14
27	57.5	54.69	30	8	16
28	59.5	56.71	30	8	16
29	61.5	58.73	30	8	16
30	63.6	60.75	30	8	16
31	65.6	62.76	30	8	16
32	67.6	64.78	30	8	16
33	69.6	66.80	30	8	16
34	71.6	68.82	30	8	16
35	73.6	70.84	30	8	16
36	75.6	72.85	30	8	16
37	77.7	74.87	30	8	16
38	79.7	76.89	30	8	16
39	81.7	78.91	30	8	16
40	83.7	80.93	30	8	16
41	85.7	82.95	40	10	18
42	87.8	84.97	40	10	18
43	89.8	86.98	40	10	18
44	91.8	89.01	40	10	18
45	93.8	91.03	40	10	18
46	95.8	93.05	40	10	18
47	97.9	95.07	40	10	18
48	99.9	97.09	40	10	18
49	101.9	99.10	40	10	18
50	103.9	101.13	40	10	18
51	105.9	103.14	40	10	18
52	108.0	105.16	40	10	18
53	110.0	107.18	40	10	18
54	112.0	109.18	40	10	18
55	114.0	111.23	40	10	18
56	116.0	113.25	40	10	18
57	118.1	115.27	40	10	18
58	120.1	117.29	50	10	20
59	122.1	119.31	50	10	20
60	124.1	121.32	50	10	20
62	128.2	125.37	50	10	20
64	132.2	129.41	50	10	20
65	134.2	131.43	50	10	20
66	136.2	133.45	50	10	20
68	140.3	137.49	50	10	20
70	144.3	141.53	50	10	20
72	148.4	145.58	50	10	20
75	154.4	151.63	50	10	20
76	156.5	153.66	50	10	20
78	160.5	157.70	70	10	30
80	164.5	161.74	70	10	30
85	174.6	171.85	70	10	30
90	184.7	181.95	70	10	30
95	194.8	192.05	70	10	30
100	204.9	202.15	70	10	30
110	225.1	222.37	70	10	30
114	233.2	230.45	70	10	30
120	245.4	242.58	70	10	30
125	255.5	252.68	70	10	30

1/4"×1/8"

SPROCKETS 1/4"×1/8"

For chain Acc.to DIN 8187
ISO/R606

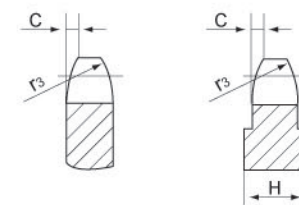
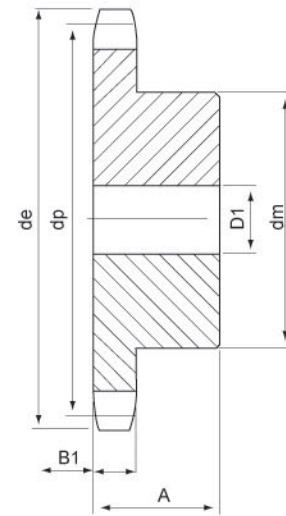

SPROCKETS mm

Tooth radius r ₃	6.4
Radius width C	0.7
Tooth width B ₁	2.9

CHAIN mm

Pitch	6.35
Internal width	3.18
Roller Φ	3.3

H=4mm, From Z=62 the width of the plate is increased

Z	d _e	d _p	S
			D ₁
8	19.4	16.58	6
9	21.4	18.56	6
10	23.3	20.55	6
11	25.3	22.54	8
12	27.3	24.53	8
13	29.3	26.53	8
14	31.3	28.53	8
15	33.3	30.53	8
16	35.3	32.55	8
17	37.3	34.55	8
18	39.4	36.56	8
19	41.4	38.58	8
20	43.4	40.58	8
21	45.4	42.60	8
22	47.4	44.62	8
23	49.4	46.63	8
24	51.4	48.64	8
25	53.5	50.66	8
26	55.5	52.67	8
27	57.5	54.69	8
28	59.5	56.71	8
29	61.5	58.73	8
30	63.6	60.75	8
31	65.6	62.76	10
32	67.6	64.78	10
33	69.6	66.80	10
34	71.6	68.82	10
35	73.6	70.84	10
36	75.6	72.85	10
37	77.7	74.87	10
38	79.7	76.89	10
39	81.7	78.91	10
40	83.7	80.93	10
41	85.7	82.95	10
42	87.8	84.97	10
43	89.8	86.98	10
44	91.8	89.01	10
45	93.8	91.03	10
46	95.8	93.05	10
47	97.9	95.07	10
48	99.9	97.09	10
49	101.9	99.10	10
50	103.9	101.13	10
51	105.9	103.14	12
52	108.0	105.16	12
53	110.0	107.18	12
54	112.0	109.18	12
55	114.0	111.23	12
56	116.0	113.25	12
57	118.1	115.27	12
58	120.1	117.29	12
59	122.1	119.31	12
60	124.1	121.32	12
62	128.2	125.37	12
64	132.2	129.41	12
65	134.2	131.43	12
66	136.2	133.45	14
68	140.3	137.49	14
70	144.3	141.53	14
72	148.4	145.58	14
75	154.4	151.63	14
76	156.5	153.66	14
78	160.5	157.70	16
80	164.5	161.74	16
85	174.6	171.85	16
90	184.7	181.95	16
95	194.8	192.05	16
100	204.9	202.15	16
110	225.1	222.37	16
114	233.2	230.45	16
120	245.4	242.58	16
125	255.5	252.68	16

1/4"×1/8"

PLATEWHEELS 1/4"×1/8"

For chain Acc.to DIN 8187
ISO/R606

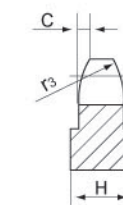
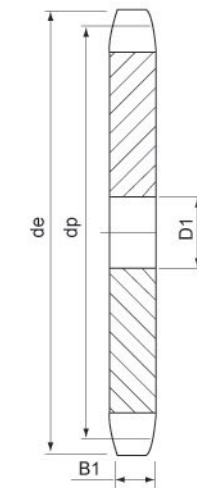

PLATEWHEELS mm

Tooth radius r ₃	6.4
Radius width C	0.7
Tooth width B ₁	2.9

CHAIN mm

Pitch	6.35
Internal width	3.18
Roller Φ	3.3

H=4mm, From Z=51 the width of the plate is increased