

American & British Standard Chain Attachments

BA-1 (One side)

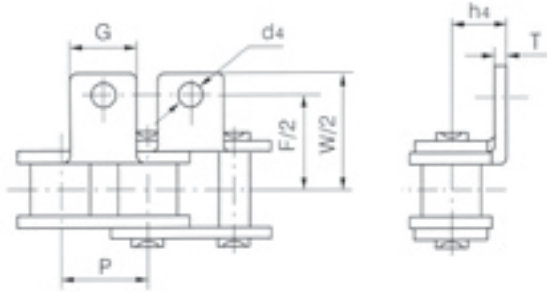

BK-1 (Both sides)

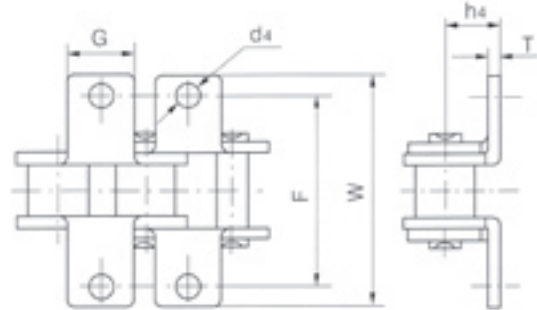

Chain No.	P	G	F	W	T	h4	d4
	mm	mm	mm	mm	mm	mm	mm
35	9.525	7.95	19.00	26.2	1.30	6.35	2.8
40	12.700	9.50	25.40	35.2	1.50	7.90	3.4
50	15.875	12.70	31.75	46.2	2.03	10.30	5.5
60	19.050	15.90	38.10	55.6	2.42	11.90	5.5
80	25.400	19.10	50.80	64.8	3.25	15.90	6.8
100	31.750	25.40	63.50	87.3	4.00	19.80	9.2
120	38.100	28.60	76.20	108.5	4.80	23.00	9.8
140	44.450	34.90	88.90	123.0	5.60	28.60	11.4
160	50.800	38.10	101.60	142.8	6.40	31.75	13.1
06B	9.525	8.00	19.04	27.0	1.30	6.50	3.5
08B	12.700	9.50	25.40	36.4	1.60	8.90	4.5
10B	15.875	14.30	31.75	44.6	1.70	10.31	5.3
12B	19.050	16.00	38.10	52.4	1.85	13.46	6.4
16B	25.400	19.10	50.80	72.6	3.10	15.88	6.4
20B	31.750	35.00	63.50	100.5	3.50	19.80	9.0
24B	38.100	30.00	76.20	108.4	4.80	26.67	10.5
28B	44.450	35.00	88.90	123.0	6.00	28.58	13.1
32B	50.800	38.10	101.60	142.8	6.00	31.75	13.1